

ROYAL  ALBATROSS

# THE LUXURY TALL SHIP



*Welcome Onboard!*





## WHAT'S IN A NAME?

EVERYTHING! IT'S OUR IDENTITY, SO WE WANTED IT TO REPRESENT KEY VALUES ABOUT OUR SHIP. THE ROYAL ALBATROSS IS A RARE SEA BIRD SPECIES AND THE SECOND LARGEST OF THE 22 MEMBER ALBATROSS FAMILY.

SIMILARLY, THE SHIP IS LARGE AND IT HAS ONE SAIL FOR EACH OF THE 22 SPECIES. THE ALBATROSS, LIKE THE SHIP, COVERS GREAT DISTANCES AT SEA ELEGANTLY AND SWIFTLY WITH ITS GIANT WINGSPAN. HISTORICALLY, IT'S REGARDED BY SAILORS AS LUCKY TO SIGHT ONE, AS FOLLOWING AN ALBATROSS LEADS TO LAND.

## HOW TO READ OUR LOGO?

THESE FOUR CHINESE CHARACTERS REPRESENT THE ROYAL ALBATROSS' FOUR MASTS. IT MEANS BEAUTIFUL, SAILING, AUSPICIOUS SHIP.



美 [méi]

Beautiful



帆 [fān]

Sails



吉 [jí]

Auspicious



舟 [zhōu]

Ship

THE ROYAL ALBATROSS IS ONE OF A KIND AND NOT TO BE FOUND ANYWHERE ELSE IN THE WORLD. SHE IS THE DEFINITION OF *UNIQUE* AND THEREFORE ABLE TO OFFER A TRULY EXCEPTIONAL EXPERIENCE THAT BONDS HER GUESTS TOGETHER, SHARING A LIFELONG MEMORY. THE ROYAL ALBATROSS BOASTS A LABYRINTH OF ROPES, SAILS AND HANDCRAFTED WOODWORK, ALL IN AN EXTRAORDINARY LAVISH AMBIANCE NOT NORMALLY FOUND ON VESSELS OF THIS KIND.

WELCOME TO THE GOLDEN AGE OF LUXURY TALL SHIP SAILING, COMBINED WITH THE SAFETY AND CONVENIENCES OF MODERN ERA AND TECHNOLOGY.



## PARTICULARS (HER VITAL STATISTICS)

CREW	12	LENGTH	47M
DAY SAILING CAPACITY	149 PAX	SAILS	22 (653 SQ.METERS)
ALONGSIDE CAPACITY	200+ PAX	BEAM	7.6M
OVERNIGHT CHARTER	10 PAX	RIG	STAYSAIL (W/SQUARESAIL)
BUILT	2001	DRAFT	3.8M
TYPE	BARQUENTINE (CLASS-A)	AIR DRAFT	28.5M
FLAG	LANGKAWI	GRT	193 TONS
CLASS	RINA YACHT	ENGINE	1 X 430 HP
HULL	STEEL	DISPLACEMENT	270 TONS
MASTS	4 ALUMINIUM MASTS	MAX SPEED	10 KNOTS



# POINTS OF SPECIAL INTEREST

THE ROYAL ALBATROSS IS ONE OF A KIND AND NOT TO BE FOUND ANYWHERE ELSE IN THE WORLD. SHE IS THE DEFINITION OF UNIQUE.

## THE BOW SPRIT



## HER FEMININITY

Royal Albatross is a Tall Ship. That means she is a traditional old-fashioned ship with tall masts. By the way, all ships are referred to as "she". Extending 10m out in front of the ship, the bow sprit provides an anchor point for the forestays and allows the foremast to be stepped further forward.

## THE PIN RAILS



## LEARNING THE ROPES

All 200+ ropes have a special place on their "pin rail" which is where they are secured using a belaying pin. The belaying pin can be pulled out if it's necessary to quickly depower the sails. The phrase "learning the ropes" comes from tall ships where the crew had to learn the position and purpose of every rope.

## THE FLYING SEAT



## CRAFTED WITH LOVE

With around 150 tall ships left worldwide and only a handful in passenger service, the Royal Albatross is a rare manually operated sailing ship requiring traditional and specialist skills to operate and maintain her. She was handcrafted by her loving crew and owner during a 6-year refurbishment.

## THE MONKEY BAR



## TO GREATER HEIGHTS

The Monkey Island is located on top of the bar roof and is a fully equipped sound stage where bands and performers entertain regularly. Monkey Island is the name given to the highest accessible point on a ship where sailors would go to perform solar and stellar observations.

## THE HELM STATION



## HER CLASSIFICATION

The Royal Albatross is a RINA classified "Class A" tall ship, meaning she is a square rigged sailing ship over 40m in length. Specifically she is a Barquentine, meaning her square sails are located on the foremast. Under the surface, she is equipped with the latest navigation and safety technologies.

## THE GRAND SALON



## FEATURED IN HOLLYWOOD

The ship's interior is made from Kempas - a local hardwood over 100 years old. All the carpentry onboard was handcrafted by the ship's crew. Royal Albatross' claim to fame was being featured as Bruce Wayne's private yacht in the second Batman movie "The Dark Knight" starring Christian Bale and the late Heath Ledger.

## OWNER'S CABIN



## GOLDEN AGE OF SAIL

Tall Ships were the form of transport in the mid-19th century, equivalent of today's container ships, passenger cruise ships and warships. The Royal Albatross is not equipped for trade or warfare, but it provides the chance for visitors to experience what it must have been like to sail a tall ship in a bygone era!



# DECK LAYOUTS

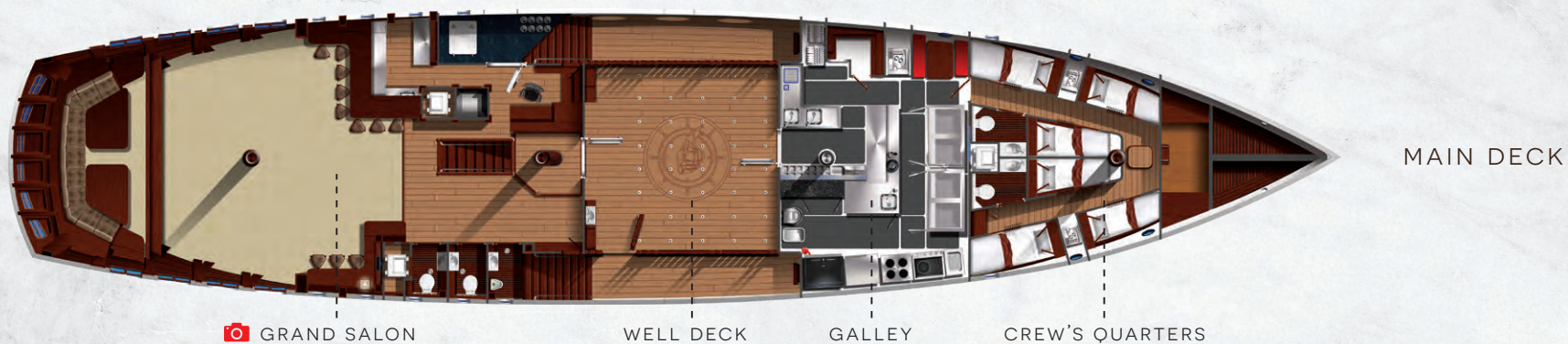
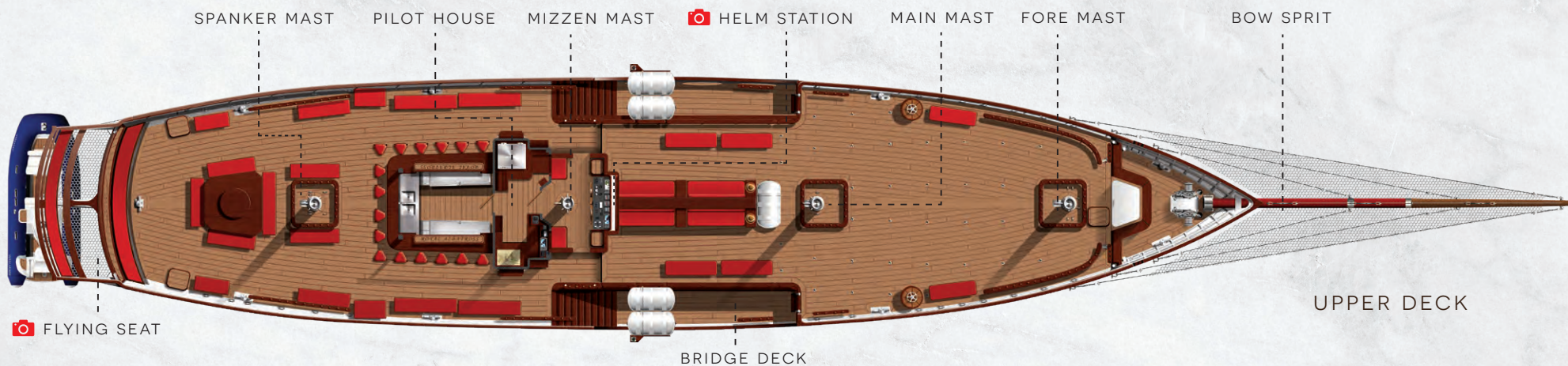

## LEGEND

 PHOTO AREA



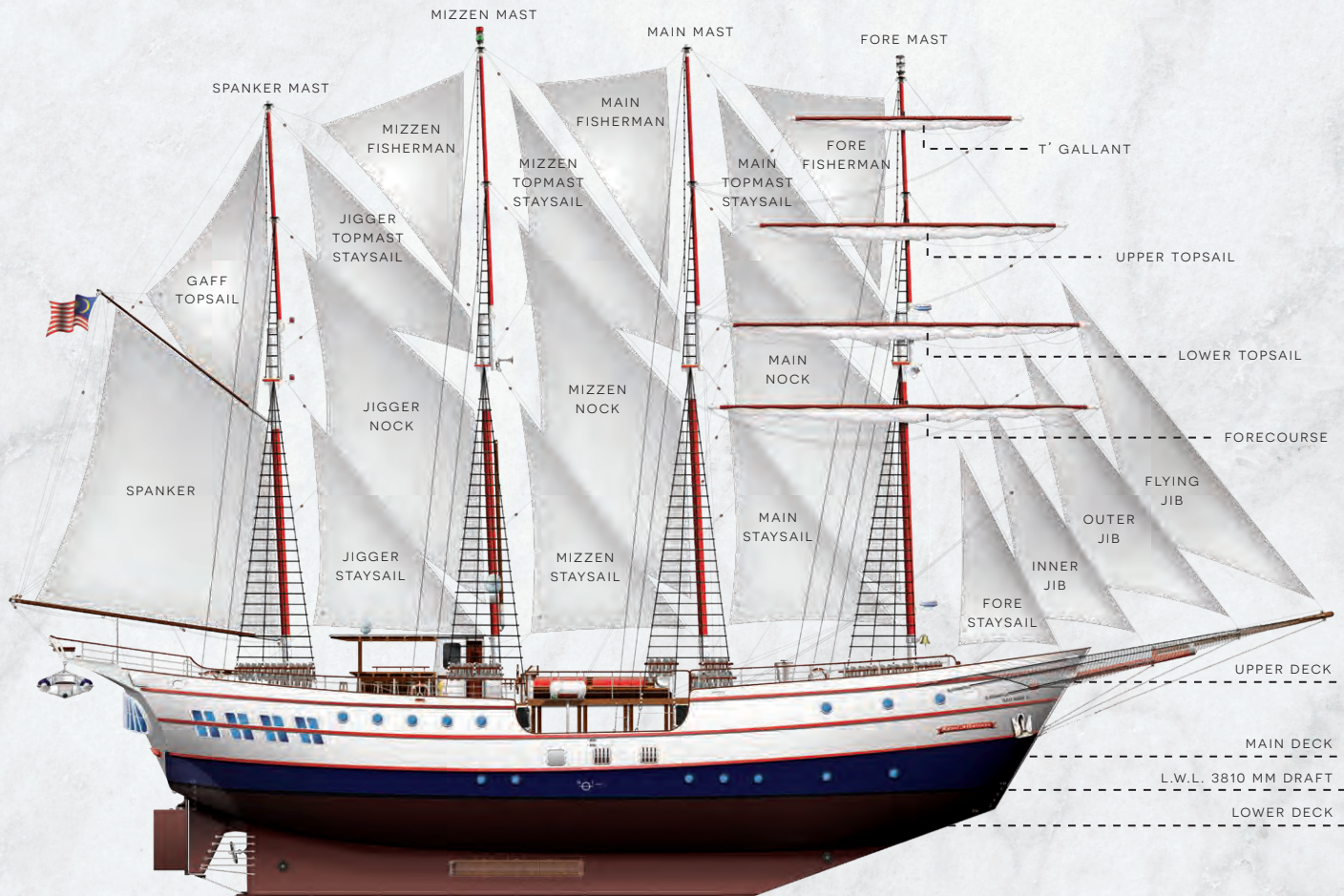

FOR CORPORATE, PRIVATE AND WEDDING CHARTER ENQUIRIES, PLEASE CONTACT +65 6863 9585 | [INFO@TALLSHIP.COM.SG](mailto:INFO@TALLSHIP.COM.SG)